

StareCasing Sizing Guide

Round Design- StareTread™

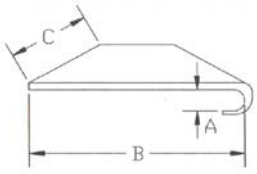

	Standard
A	1-1/16"
B	11"
C	36", 42", 48"

Thickness = 3/8"
 Custom length (C) available up to 86"
 Custom depth (B) available up to 18"

2x Design- StareTread™

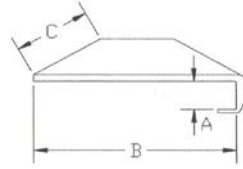

	Standard
A	1-1/2"
B	11"
C	36", 42", 48"

Thickness = 3/8"
 Custom length (C) available up to 86"
 Custom depth (B) available up to 18"

Boxed Design- StareTread™

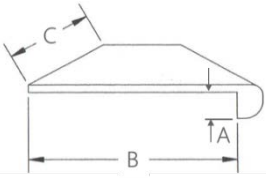

	Standard
A	1-1/4"
B	10"
C	36", 42", 48"

Thickness = 3/8"
 Custom length (C) available up to 86"
 Custom depth (B) available up to 17"

StareRiser™

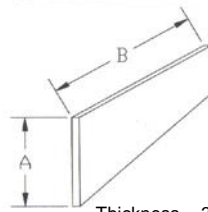

	Standard
A	7"
B	36", 42", 48"

Thickness = 3/8"
 Custom length (B) available up to 96"
 Custom height (A) available up to 18"

Landing Material

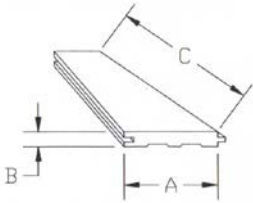

	Standard
A	2.25"
B	3/8"
C	40"

Custom landing materials are not available

3/8" or 3/4" StareNosing™

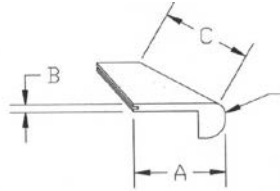

	Standard
A	4.5"
B	3/8" or 3/4"
C	48"
D	Round or 2X

Single Return StareTread™

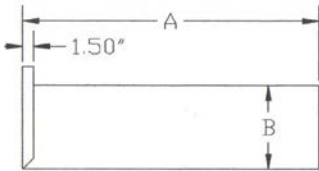

	Standard
A	48"
B	11"
C	Round

C = Tread type (Round, 2X, or Boxed)
 Thickness = 3/8"
 2x Return Treads do not come pre-assembled. 2x Return cap sold separately.

Double Return StareTread™

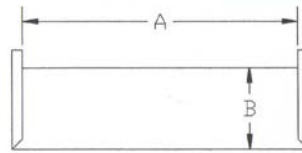

C = Tread type (Round, 2X, or Boxed)
 Thickness = 3/8"

- Custom Order Only
- 2x Return Treads do not come pre-assembled. 2x Return Caps sold separately.
- Custom length (A) up to 93"
- Custom depth (B) up to 18"

Starting Step (R/L) StareTread™

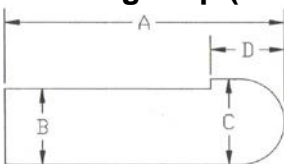

Custom Order Only

Thickness = 3/8"

Starting Step (DBL) StareTread™

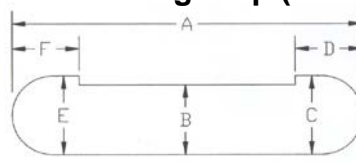

Custom Order Only

Thickness = 3/8"